



PRICE GUIDE: \$400,000.00

Area: 647 m2

Near New Spacious Home!

This beautifully presented family home offers a warm ambiance rarely found in modern homes. Situated in a quiet pocket, the home has been built to a faultless quality and has been impeccably maintained.

THE PROPERTY

- 4 Large bedrooms with BIR
- Master bedroom with WIR & private ensuite
- Study
- Large open plan living/dining area
- Stunning kitchen with island bench
- Ample storage & stainless steel appliances
- Theatre room
- Beautiful neutral tone throughout
- Well designed floorplan
- Family sized main bathroom with separate bath and shower
- Spacious tiled patio
- Fully air conditioned



Shelly Lynham
0414 250 166



OFFICE

37Thuringowa Drive, Kirwan
07 4723 3222

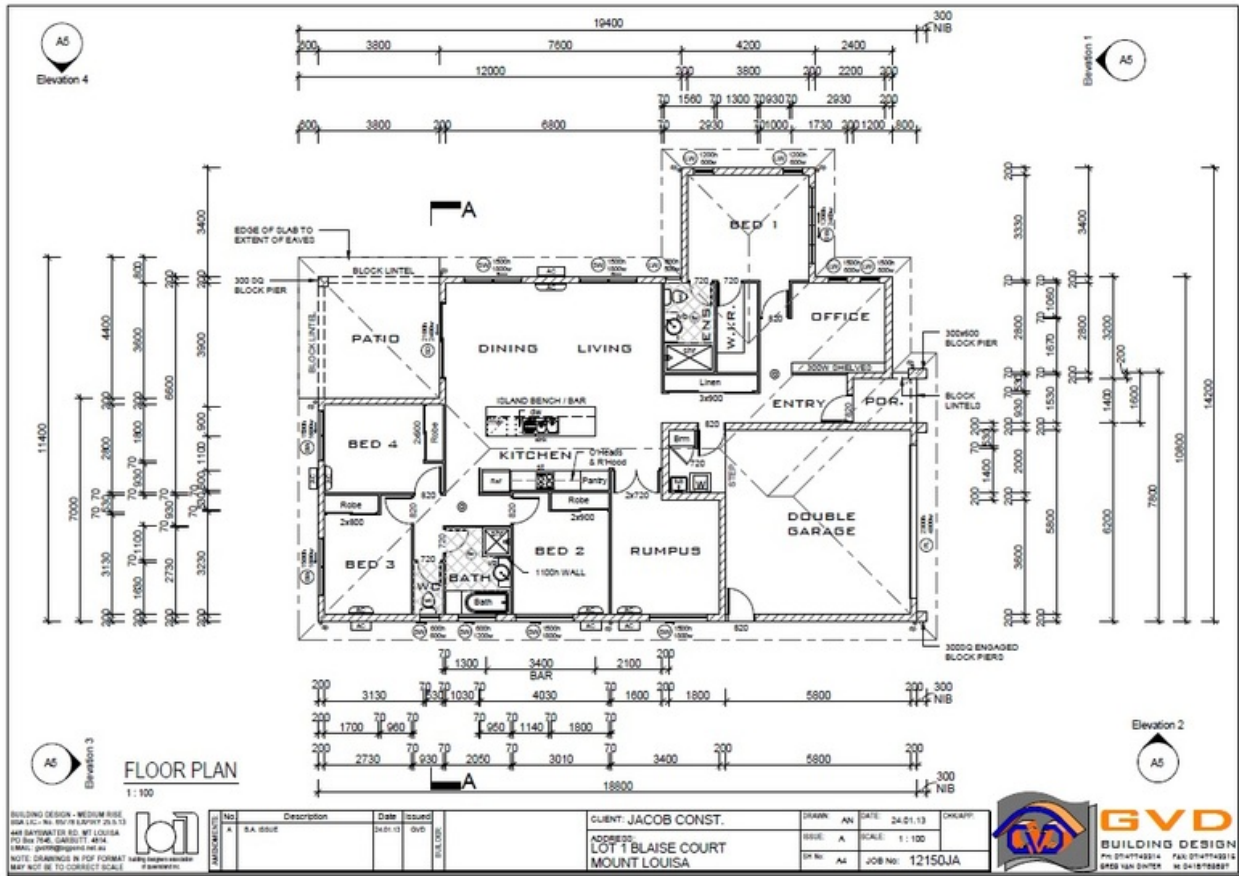

FLOOR PLAN

1:100

BUILDING DESIGN - MEDIUM RISE
 BSA LIC. NO. 20198 (EXPIRES 20-11)
 445 BAYVIEW TERR. #11 LOUISA
 QLD 4701, AUSTRALIA
 URBAN: GVD@BDDDESIGN.COM.AU
 NOTE: DIMENSIONS IN PDF FORMAT
 MAY NOT BE TO CORRECT SCALE

NO.	DESCRIPTION	DATE ISSUED	BY	CHECKED
A	BA ISSUE	24.01.13	GVD	

CLIENT: JACOB CONST.
 ADDRESS: LOT 1 BLAISE COURT
 MOUNT LOUISA

DRAWN: AN
 DATE: 24.01.13
 CHECKED: A
 SCALE: 1:100
 JOB NO: 12150JA

