



PRICE GUIDE: \$290,000.00

Area: 647 m²

Council Rates: \$3,997.58 p.q.

Under Contract By Nathan Lynham 0427695162

Resting in an idyllic central location on a 647sqm allotment, this well-appointed family home is perfect for young couples, families or investors. It's situated in a quiet street, within walking distance to shops, schools and transport.

THE PROPERTY:

- 3 large bedrooms
- Large open plan lounge with separate dining
- Large central kitchen with ample storage
- Renovated bathroom with separate toilet
- Private patio off the lounge area
- In-ground pool
- Fully re-painted with new carpet throughout
- Internal laundry
- Single carport at the front
- Fenced yard
- Rates - \$3,997.58 per year
- Close proximity to Stockland shopping cent



Nathan Lynham
0427 695 162



Graham Lynham
0447 250 222



OFFICE

37Thuringowa Drive, Kirwan
07 4723 3222

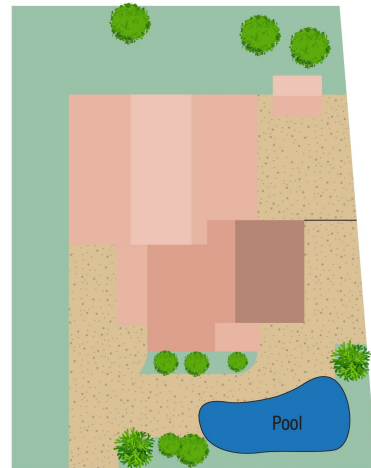
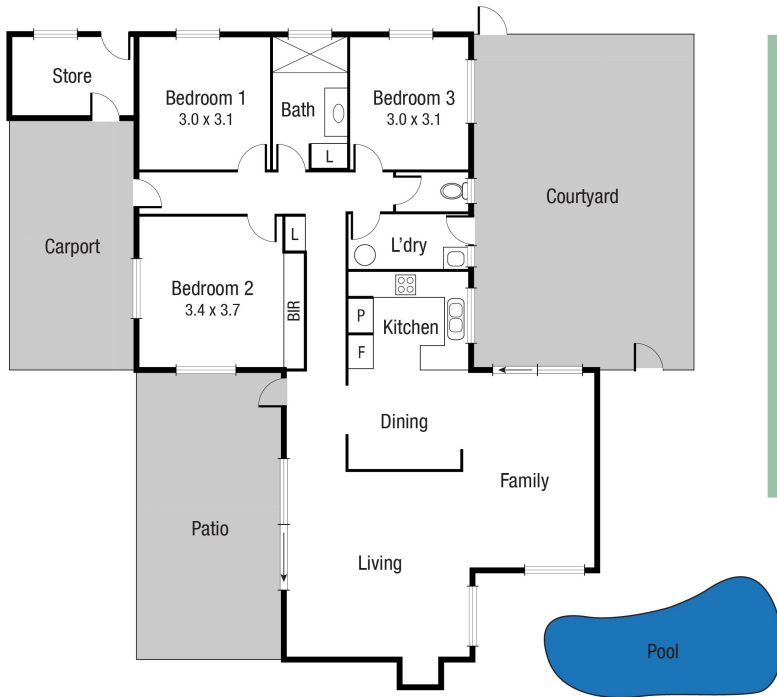

Scale in metres. Indicative only. Dimensions are approximate. All information contained herein is gathered from sources we believe to be reliable. However we cannot guarantee its accuracy and interested persons should rely on their own enquiries.

TOTAL AREA : 187.5 sq.m

12 Fuller St, Heatley